



\$220,000 USD

Betanya

Cabo Corridor

PROPERTY TYPE Condos	AREA 1,334 m²
BEDROOMS 2	BATHROOMS 2
MLS NUMBER 25-2241	

Description

Located in one of the city's most sought-after and fastest-growing areas, El Tezal, this stunning penthouse offers exceptional value in a boutique building with only 8 units over 3 levels, ensuring privacy and a peaceful atmosphere.

Property features:

2 spacious bedrooms

2 full bathrooms

Living and dining area with partial ocean views

Fully equipped kitchen

Assigned parking space

Just 5 minutes from Costco, Soriana Hyper, Fresko, Home Depot, restaurants, pharmacies, and public transportation, and only 10 minutes from the beach.

With the most competitive price in the area and a highly motivated seller open to offers, this is a perfect opportunity for short- or long-ter

Property Gallery

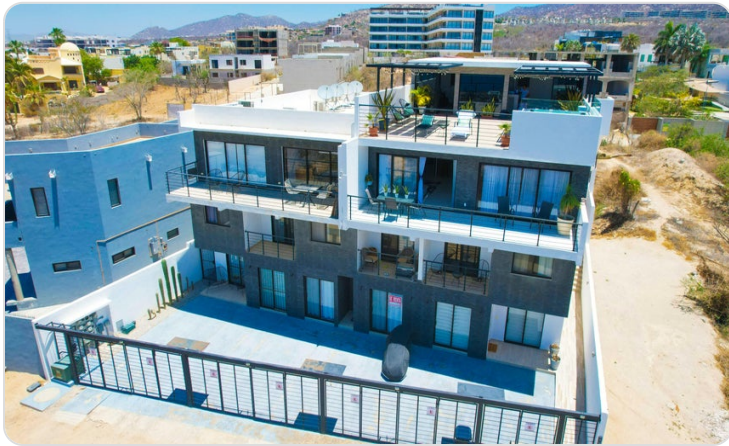

Property Location

Cabo Corridor

Betanya

Latitude
22.907259

Longitude
-109.870166

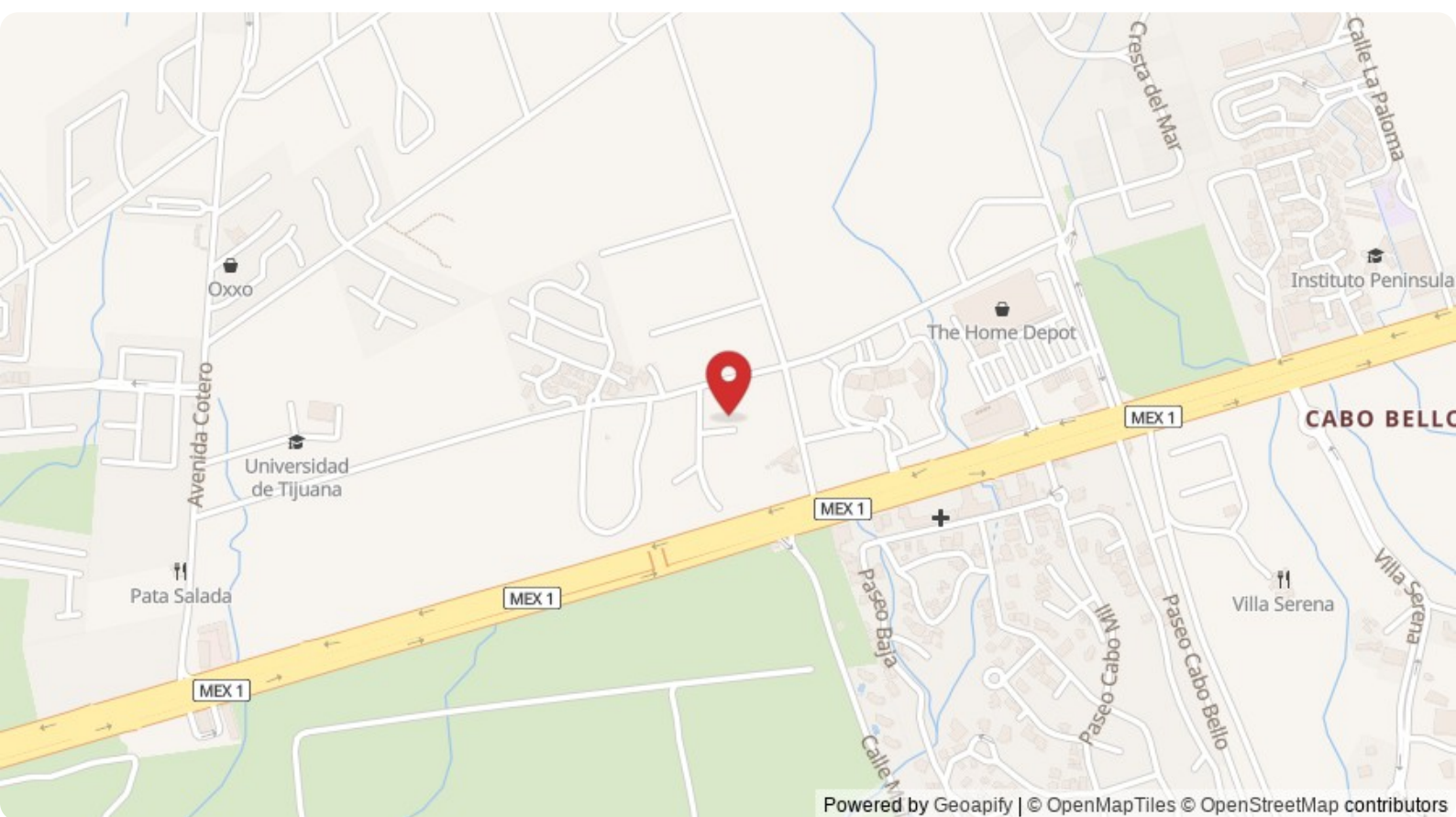

Scan QR to view property online



<https://beincabo.com/property-detail/?mls=25-2241>